

SharkBite® Heatguard® 115-D Series

DESCRIPTION

The Cash Acme SharkBite® Heatguard® 115-D is a large sized high flow rate Temperature Actuated Mixing Valve that mixes hot water with cold to deliver tempered water at a controlled temperature to 120°F (49°C) maximum.

The Cash Acme SharkBite® Heatguard® 115-D is intended for installation at the water heater to distribute controlled temperature water throughout a domestic hot water system. The valve delivers water at a maximum of 120°F (49°C), allowing the heater to be set at 140°F (60°C) or higher, thus providing a greater effective volume of hot water and reducing the chances of legionella bacteria growth in the water. The valve flows 30 gpm at 45 psi, making it suitable for larger residential and commercial installations.

The Cash Acme SharkBite® Heatguard® 115-D is a high quality mixing valve incorporating the latest in Thermostatic Technology. It features a robust design based on the expertise gained from years of experience in the design and manufacture of safety valves. Every valve is tested for performance on an automated testing station during the assembly process.

The Cash Acme SharkBite® Heatguard® 115-D incorporates a fast acting, high quality thermostatic element that senses the outlet water temperature and reacts to maintain a stable delivery temperature even under changing flows or variations in supply temperatures. The valve also greatly reduces the outlet flow in the event of a cold water supply failure.

The Cash Acme SharkBite® Heatguard® 115-D features an adjusting handle that can be locked at a desired temperature. Alternatively it can function in an adjusting mode, with the handle clearly marked to indicate the direction to turn to achieve hotter or colder water temperatures.

The Cash Acme SharkBite® Heatguard® 115-D is available as a base valve with union connections to suit the range of Heatguard 115 Fittings Kits in 3/4" and 1" sizes, including sweat and threaded.

FEATURES AND BENEFITS

Instant push-fit connection for increased ease of use:

No soldering, glue or tools required.

Delivers water at a maximum of 120°F (49°C) throughout the system:

Safer hot water from all outlets.

Allows the heater to be set at 140°F (60°C) or higher:

Greater effective hot water volume, less chance of legionella within the cylinder.

Large sized valve with high flow rates:

Single valve can supply controlled water to a large installation.

Robust, low complexity construction:

Superior reliability, improved user safety.

Integral union connections on all three ports:

Easy and quick to install and service.

Listed by IAPMO and ASSE:

Inspector friendly, peace of mind!

SPECIFICATION

A Temperature Actuated Mixing Valve shall be installed at the water heater to distribute tempered water throughout the domestic hot water system at a maximum of 120°F (49°C). The temperature actuated mixing valve shall control the delivered water temperature via a regulating piston made from engineering polymer. The valve shall be a Cash Acme SharkBite® Heatguard® 115-D.

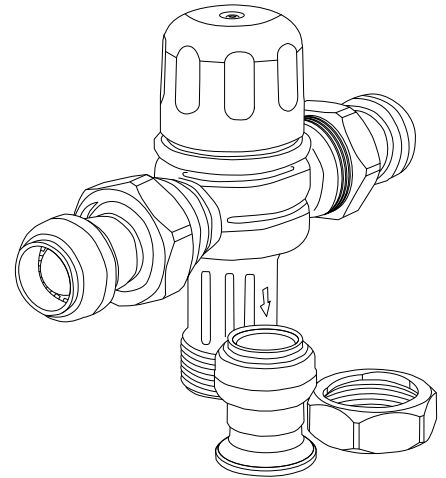

HEATGUARD®
THERMOSTATIC MIXING VALVES

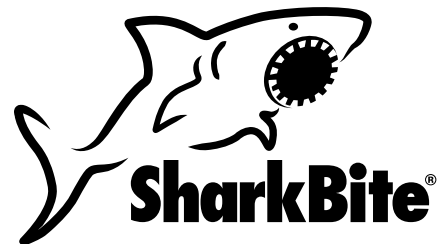

SharkBite® Heatguard® 115-D Series

TYPICAL INSTALLATION

To control water temperature at the source of heat (hot water tank) to provide a safe distribution of temperature.

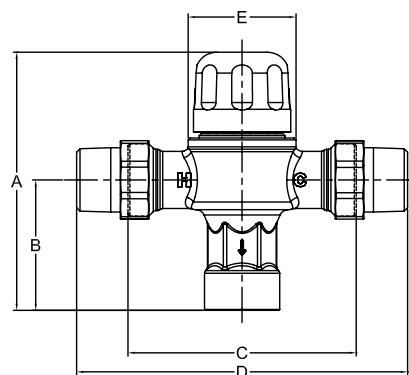
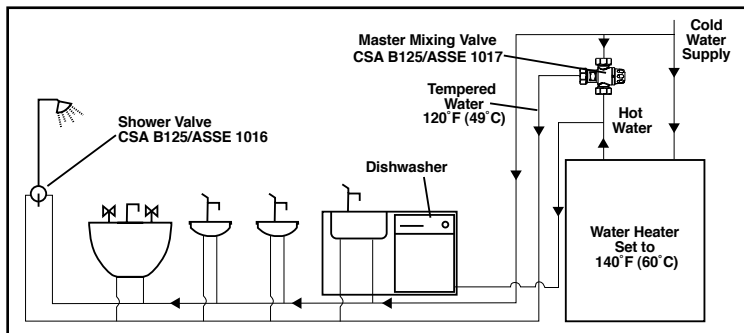

SPECIFICATION DATA

Performance:

Outlet temperature range 95 - 120°F (35 - 49°C)

Temperature hot supply 195°F (90°C) max

Temperature cold supply 40 - 80°F (4 - 27°C)

Temperature stability +/- 5°F (3°C)

Working pressure, maximum . . . 145 psi (1,000 kPa)

Flow rate, maximum 50 gpm (190 L/min)

Flow rate, minimum 2.5 gpm (10 L/min)*

Dimensions	A	B	C	D	E
Base Valve	5.93 (150.5)	3.15 (80)	5.34 (136)	*	2.7 (68)
3/4 SharkBite w/o check	7.44 (189)	4.66 (118.3)	*	8.36 (212.13)	2.7 (68)
3/4 SharkBite w/check	7.44 (189)	4.66 (118.3)	*	8.36 (212.13)	2.7 (68)

SharkBite® Materials:

Body DZR brass

O-Ring EPDM

Grab Ring Stainless steel

Tube Support Liner Polysulfone

Seals Nitrile elastomer

Springs Stainless steel

Fitting Brass

Internal Brass

Piston Engineered polymer

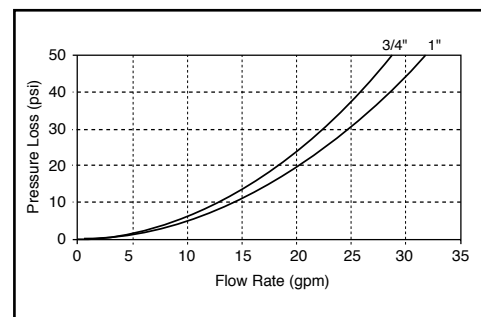

CONNECTIONS:

SharkBite w/o check 3/4"

SharkBite w/ check 3/4"

CERTIFICATIONS

The Cash Acme Heatguard® 115-D is certified to ASSE 1017 and CSA B125.3.

The Cash Acme Heatguard® 115-D is listed by ASSE and IAPMO.

*Can control temperature at lower flow rates using proper recirculating system.

Consult factory for details.